

Installation instructions:



AKRAPOVIC EVOLUTION & EVOLUTION STREET LEGAL EXHAUST SYSTEM for the APRILIA RSV 1000 (R) (01 - 03), RSV 1000 (R) (04 - 06), RSV 1000 TUONO (04 - 05), RSV 1000 R TUONO (2006)

Congratulations on purchasing an Akrapovic exhaust system. Please read these installation instructions carefully. If you have any trouble installing the system please contact your authorized dealer!

IMPORTANT INFORMATION

Exclusion of Certain Liability

1. The manufacturer, importer or dealer shall not be liable for any incidental damage including personal injury or any other damages caused by improper installation or operation of the Akrapovic exhaust system. When installing the Akrapovic exhaust system be careful that the exhaust system does not touch other parts sensitive to high temperature.
2. Akrapovic makes no representation or warranties with regard to damage caused by the improper installation, use and maintenance of the Akrapovic exhaust system. The warranty is limited to defects recognized by our technical department and to normal use, and excludes items subject to normal wear (gaskets and damping wool). The guarantee is void in case of accident, modification, improper or competition use.
3. Do not attempt to install the Akrapovic exhaust system on a motorcycle for which it was not made or tested by Akrapovic.
4. When the exhaust system gets very hot during operation, be careful not to burn yourself on the exhaust system or parts which are in direct contact with it, even when the motor is not running. Also protect other people, especially children, from the injuries mentioned above.
5. In some cases Akrapovic exhaust system kits contain chemical products (ceramic anti-seizing grease; bolt sealant). Handle with care, do not inhale or swallow. Avoid excessive contact with skin, eyes or mucous membranes. Keep out of reach of children.
6. Technical specifications of Akrapovic exhaust systems and related products subject to change without notice.

Trademarks

The Akrapovic Exhaust System Technology logo is a registered trademark of Akrapovic d.d.

Akrapovic website

Information about Akrapovic exhaust systems and related products is available on the Akrapovic website at:
<http://www.akrapovic-exhaust.com/>

Copyright

No part of the Akrapovic exhaust system or its documentation may be reproduced or distributed in any form or by any means without the prior written authorization of the Akrapovic company.

© Akrapovic d.d. All rights reserved.



Symbols

The following symbols are used throughout these installation instructions:

! CAUTION OR WARNING

🔧 INSTALLATION TIP

INSTALLATION INSTRUCTIONS

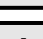
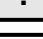
	BEFORE INSTALLING CHECK SCHEMATIC OF THE EXHAUST SYSTEM!
	IF ANY ITEMS IN THE AKRAPOVIC EXHAUST SYSTEM PACKAGE ARE MISSING PLEASE CONTACT YOUR AUTHORIZED DEALER. KEEP THE SCHEMATIC FOR FUTURE REFERENCE.
	THESE INSTALLATION INSTRUCTIONS MUST BE READ CAREFULLY IN ORDER TO ENSURE PROPER INSTALLATION AND OPERATION OF THE AKRAPOVIC EXHAUST SYSTEM.
	THE EXHAUST SYSTEM CAN BE EXTREMELY HOT. ALLOW THE MOTORCYCLE TO COOL DOWN BEFORE BEGINNING INSTALLATION.
	WE ADVISE YOU TO LEAVE INSTALLATION TO A QUALIFIED SERVICEMAN. IMPROPER INSTALLATION MAY RESULT IN A SHORTER LIFETIME OF THE EXHAUST SYSTEM AND/OR DAMAGE TO THE MOTORCYCLE.

REMOVAL OF STOCK EXHAUST SYSTEM

1. put the motorcycle on a side stand, we recommend a racing stand
2. remove the bolt from the muffler metal clamp, unhook the spring at the link pipe-collector connection and remove muffler (**Figure 1, 2**) (both sides of the motorcycle)
3. remove the bolts from the upper part of the cowl and remove the cowl (**Figure 3, 4**)
4. remove the bolts from the shield for the oil cooler and remove the shield; make sure not to damage the cooling fins (**Figure 5, 6, 7**)
5. remove the bolts from the right and middle part of the bracket for the oil cooler; make sure not to damage the cooling fins (**Figure 8, 9**)
6. Move the right oil cooler into a position which allows the stock front header tube to be removed; the cooler does not have to be disconnected; make sure not to damage the cooling fins (**Figure 10**)
7. unscrew and remove the lambda sensor (**Figure 11**)
8. remove the rubber distance cap (**Figure 12**)
9. unhook the spring on the collector (collector – header tube joint) and remove the collector (**Figure 13, 14**)
10. remove the bolts from the flanges on the stock header tubes and remove the header tubes (**Figure 15, 16, 17, 18**); make sure not to damage the cooling fins

INSTALLATION OF THE AKRAPOVIC RACING EXHAUST SYSTEM

installing the header tubes:

1. insert the front header tube and tighten the flange; make sure not to damage the cooling fins (**Figure 19, 20**)
2. insert the rear header tube and tighten the flange; (**Figure 21**)
3. make sure the header tubes are not touching the frame, engine block, water and oil cooler, other tubes, electrical installations etc.

installing the independent collector:

1. make sure the collector is correctly oriented; slide the collector onto the header tubes (**Figure 22**)
2. attach the springs on the collector (collector – header tubes joints) (**Figure 23**)
3. make sure the collector is not touching the motor or frame of the motorcycle
4. install the lambda sensor, if applicable; make sure the cable is not touching the exhaust system (**Figure 24, 25**)
5. reattach the rubber distance cap (**Figure 26**)

installing the independent link pipe:

1. make sure the link pipe is correctly oriented – loops for attaching the springs must line up
2. slide the link pipe (inlet side) onto the collector (**Figure 27**)
3. attach the springs
4. perform the process on both sides of the motorcycle
5. make sure the link pipe is not touching the frame and other parts

installing the muffler:

1. position the muffler correctly and slide it onto the outlet side of the link pipe (**Figure 28**)
2. position and attach the springs
3. perform the process on both sides of the motorcycle
4. remove the stock chassis hanging bracket (**Figure 29**)
5. in the same place install the Akrapovic carbon fiber chassis hanging bracket – use the stock bolts (**Figure 30**)
6. correctly position the carbon-fiber clamp and slide it onto the muffler - bear in mind the left offset for the right muffler and right offset for the left muffler of the carbon-fiber clamp viewed from the rear (**Figure 31**). **WARNING:** open the clamp to slightly wider than the diameter of the outer sleeve of the muffler – do not scrape it along the muffler outer sleeve! (**Figure 32**)
7. tighten the carbon-fiber clamp onto the Akrapovic carbon-fiber chassis hanging bracket on the frame (**Figure 33**)
8. make sure the mufflers are not touching other parts of the motorcycle
9. position of the installed Akrapovic Evolution system (**Figure 37**)

final installation:

1. reattach the oil cooler; make sure not to damage the cooling fins (**Figure 34**)
2. reattach the shield for the oil cooler; make sure not to damage the cooling fins (**Figure 35**)
3. tighten the bolts on all of the brackets and clamps to which the exhaust system and the other dismantled parts of the motorcycle are attached
4. clean grease spots:
 - a. muffler – titanium outer sleeve: use a soft cloth sprayed with a multi-purpose spray lubricant (WD-40 or equivalent)
 - b. muffler – carbon-fiber outer sleeve: use a soft dry cloth
 - c. titanium link pipe: use a soft cloth sprayed with a multi-purpose spray lubricant (WD-40 or equivalent)
 - d. header tubes + collector - use a soft cloth sprayed with a contact cleaner, then wipe with a soft dry clothCleaning will prevent spots from burning onto the surface. Do not use aggressive chemical cleaners, because they can damage the sticker.
5. replace all of the dismantled stock parts and cowlings in the reverse order from the order in which they were removed (**Figure 36**)

Check the operation of the brakes and suspension. Make sure all the bolts are sufficiently tightened. In case the exhaust system touches the cowling or other parts repeat the adjustment of the exhaust system or contact your authorized dealer.

! IT IS NORMAL IF WHITE SMOKE COMES OUT OF THE MUFFLER ON FIRST OPERATION.

! DO NOT STAND BEHIND THE MUFFLER ON FIRST OPERATION.

! DO NOT USE AUTOMOTIVE WHEEL CLEANERS OR ANY CLEANING PRODUCTS WHICH CONTAIN ACIDIC ADDITIVES TO CLEAN AKRAPOVIC EXHAUST SYSTEMS.

MAINTENANCE OF THE AKRAPOVIC EXHAUST SYSTEM

1. Clean the titanium muffler outer sleeve with a multi-purpose spray lubricant (WD-40 or equivalent) and carbon fiber outer sleeve with soft and dry cloth. Do not use aggressive chemical cleaners, because they can damage the sticker. A change in the color of the exhaust system is normal due to the high temperatures.
2. The wearing out of the muffler silencing material depends on the type of the motor and riding style. Contact your dealer/serviceman if visible changes appear on muffler's outer sleeve or the noise level is increased.
3. Periodically ensure that all the bolts and springs are sufficiently tight.

Photos:



Figure 1



Figure 2



Figure 3



Figure 4

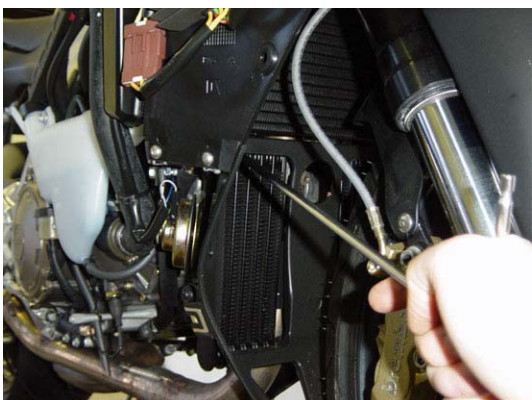

Figure 5

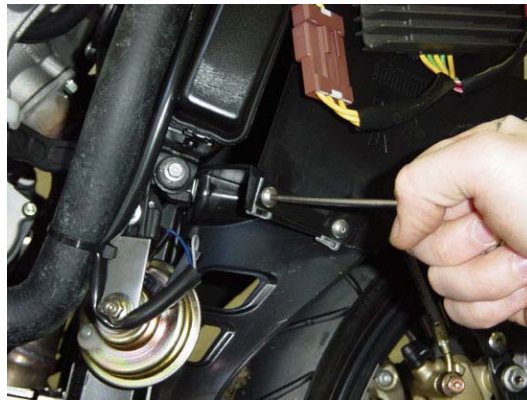

Figure 7

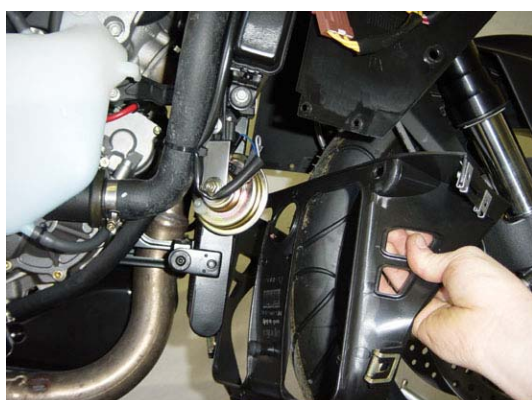

Figure 7



Figure 8



Figure 9



Figure 10



Figure 11



Figure 12

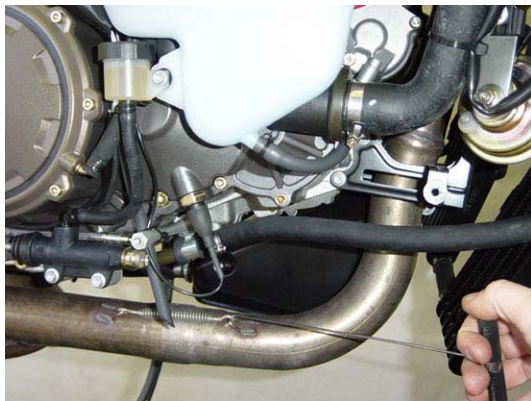

Figure 13



Figure 14



Figure 15



Figure 16



Figure 17



Figure 18



Figure 19



Figure 20



Figure 21



Figure 22

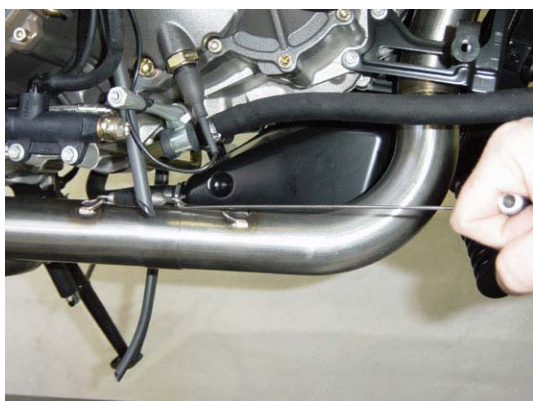

Figure 23



Figure 24



Figure 25



Figure 26



Figure 27



Figure 28



Figure 29



Figure 30

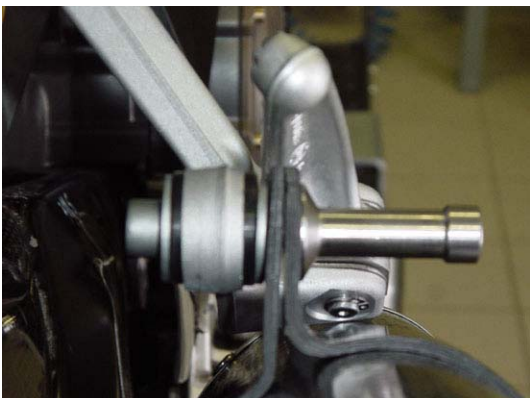

Figure 31



Figure 32



Figure 33

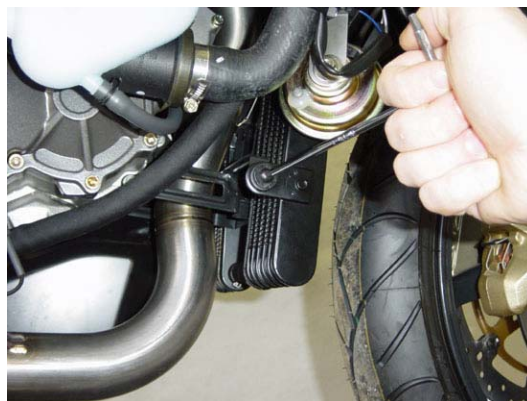

Figure 34



Figure 35



Figure 36



Figure 37

APRILIA RSV 1000 (R) Homologated complete exhaust system, model year: 2001,2002, 2003 + TUONO 2004

Product code: S-A10E2-HOT Stainless steel headers with full titanium mufflers

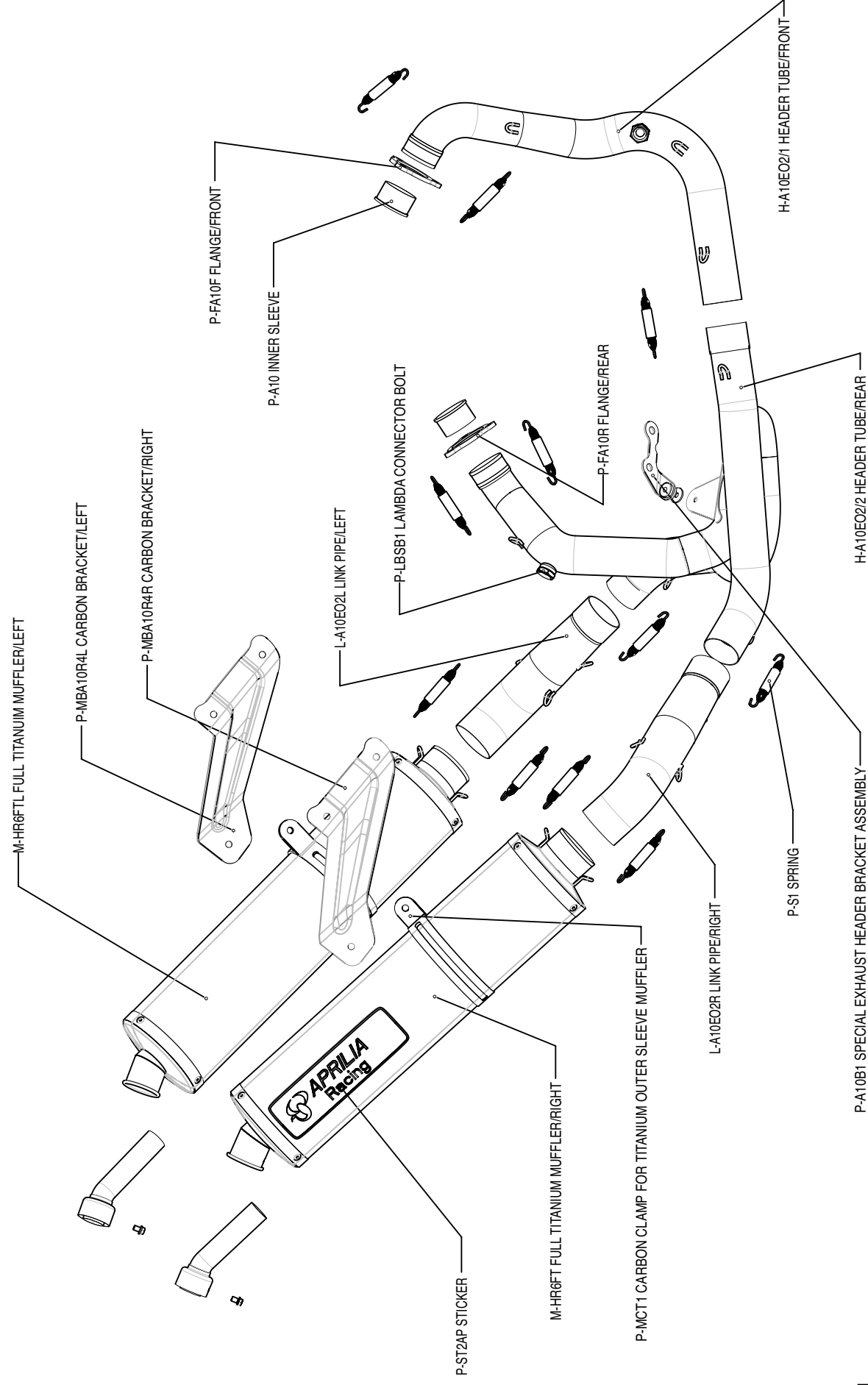

APRILIA RSV 1000 (R) Homologated complete exhaust system, model year: 2001, 2002, 2003

Product code: 103046 (S-A10E2T-HT)
103045 (S-A10E2T-HC)

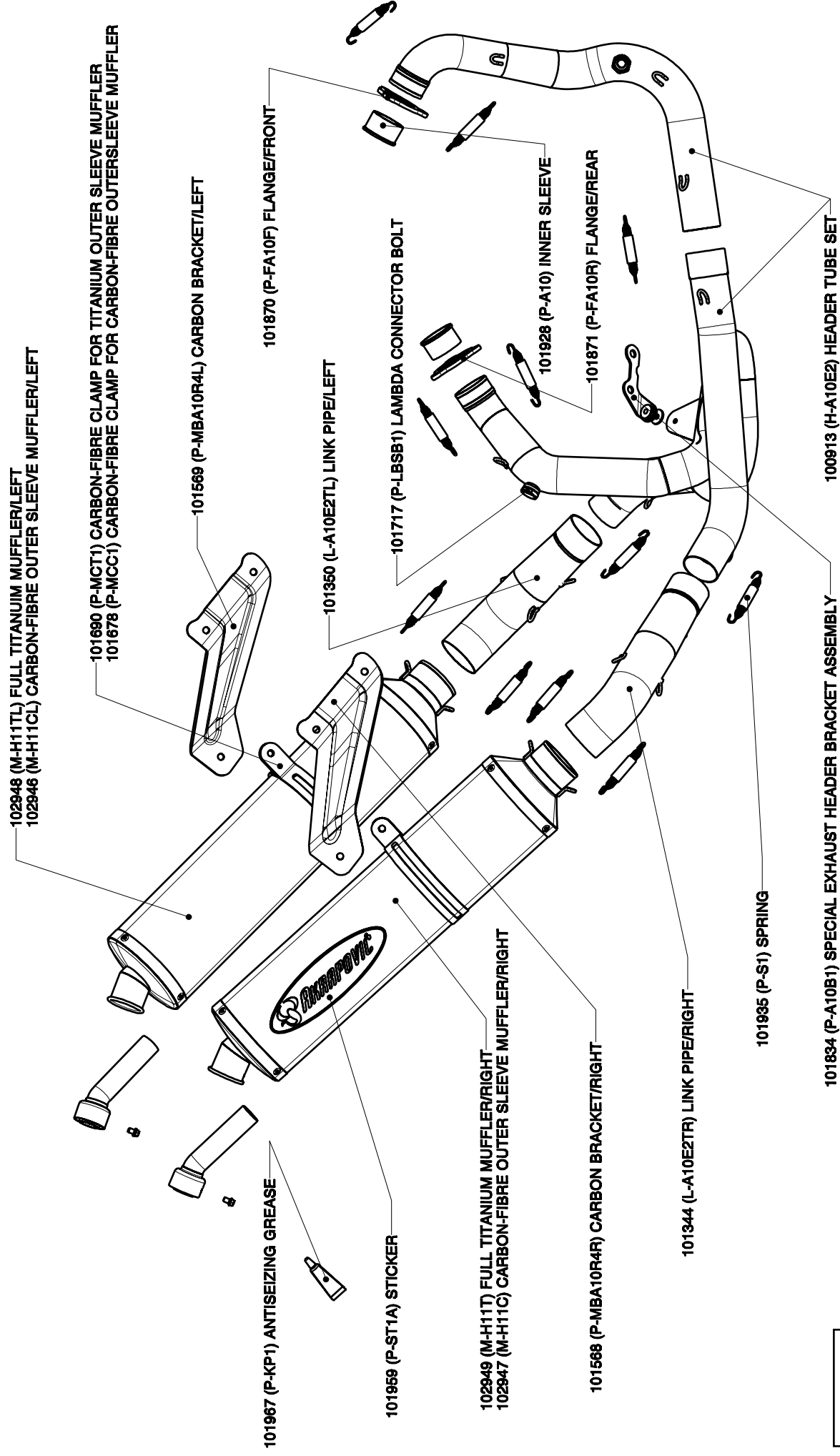

APRILIA RSV 1000(R) Homologated complete exhaust system/Racing line, model year: 2004 - 2006

TUONO 2006

Product code: S-A10E3-HOT

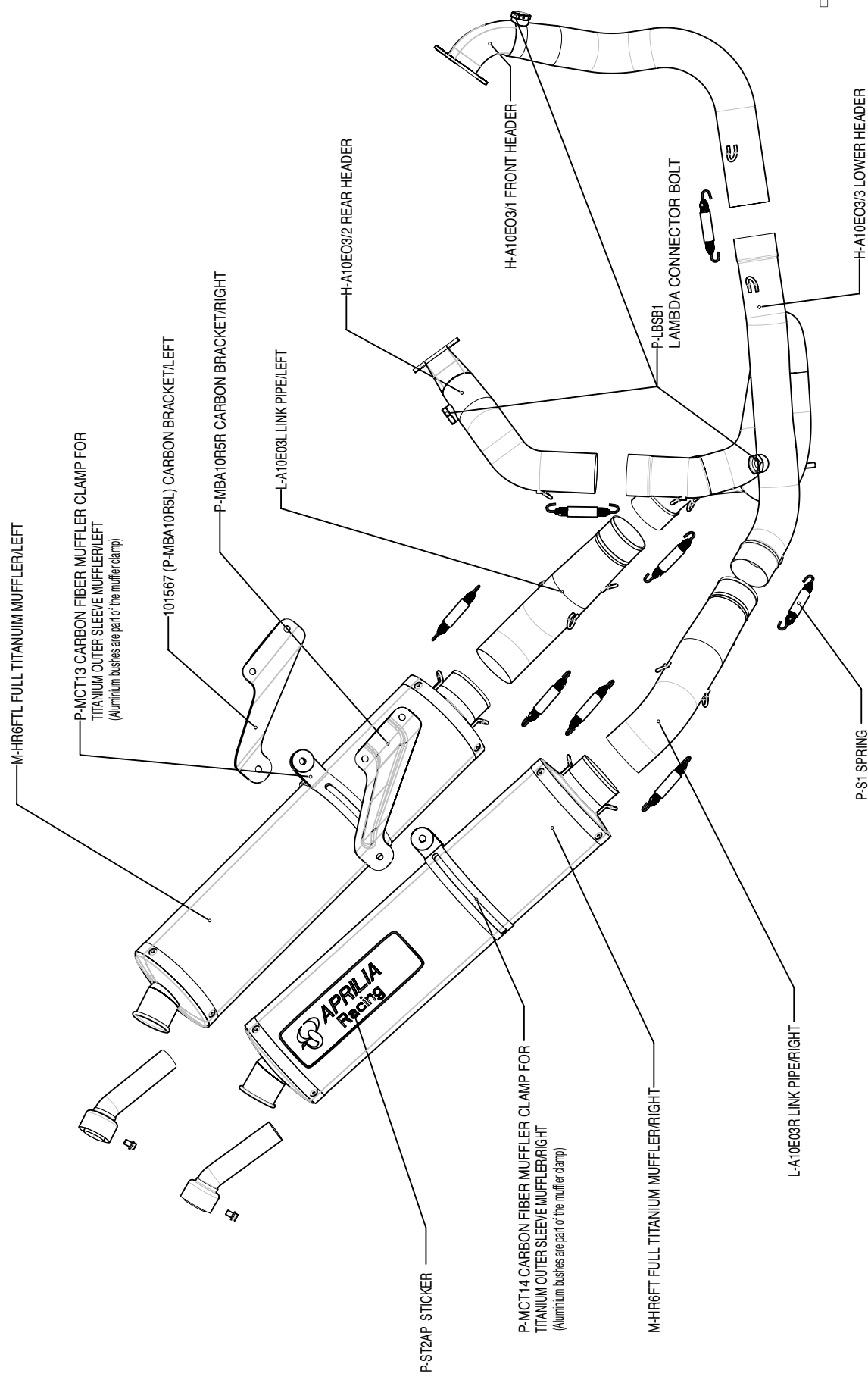

APRILIA RSV 1000(R) Complete exhaust system/Evolution line, model year: 2004-2006
 APRILIA TUONO 1000 Complete exhaust system/Evolution line, model year: 2004-2005
 APRILIA TUONO 1000(R) Complete exhaust system/Evolution line, model year: 2006

Product code: S-A10E4T-C
 S-A10E4T-T

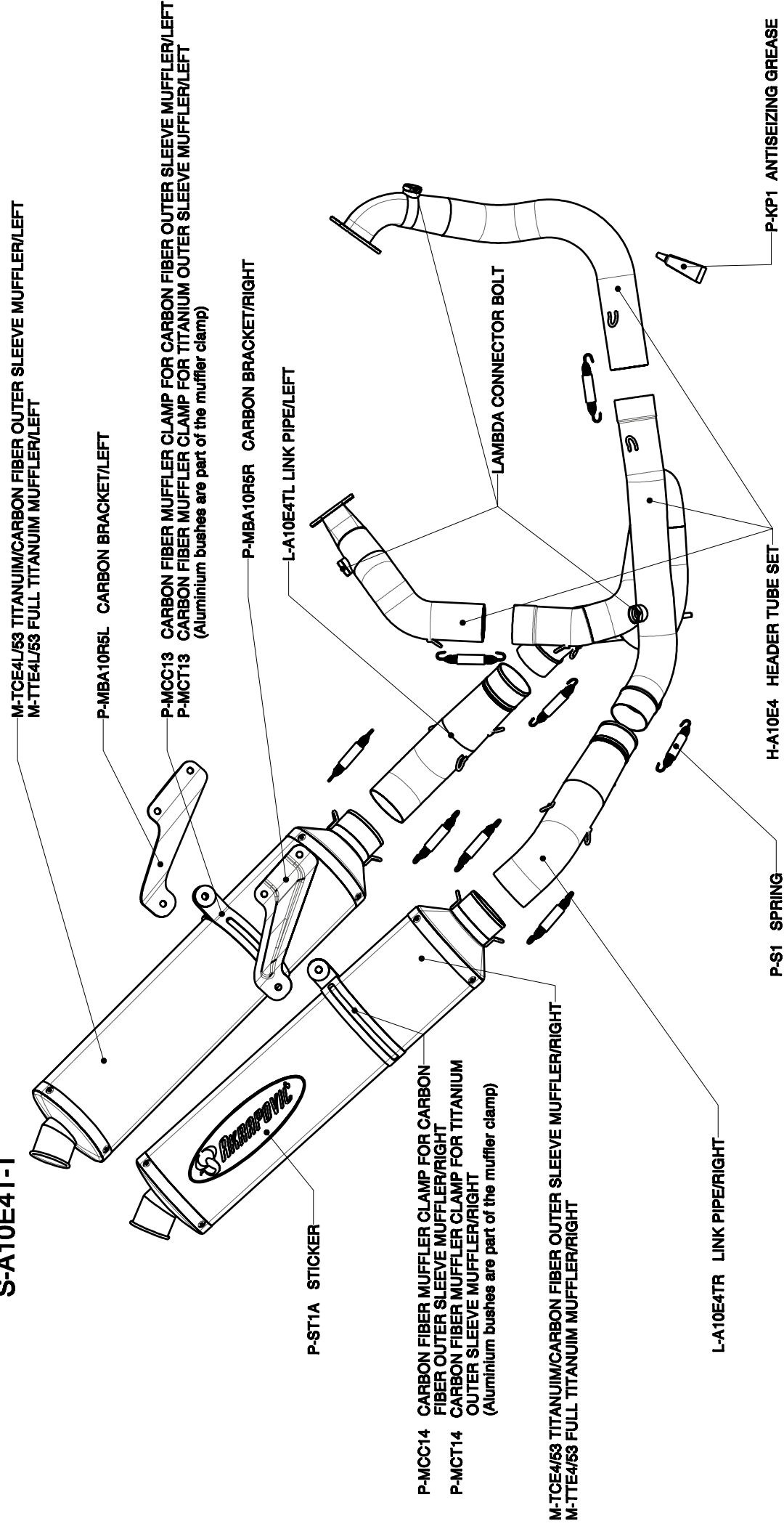

APRILIA RSV 1000(R) Homologated complete exhaust system / Evolution line, model year: 2004-2006
 APRILIA RSV 1000 TUONO Homologated complete exhaust system / Evolution line, model year: 2004-2005
 APRILIA RSV 1000R TUONO Homologated complete exhaust system / Evolution line, model year: 2006

Product code: 102944 (S-A10E4T-HC)
 102945 (S-A10E4T-HT)

